

Series LF3003

Dielectric Unions

Size: DN15-DN50

Series LF3003 dielectric unions feature a female iron pipe thread to female brass pipe thread connections. These unions are designed to be installed between pipe made from dissimilar metals to prevent accelerated corrosion and deterioration in the piping system due to galvanic and stray current. The LF3003 features Lead Free* construction to comply with Lead Free* installation requirements.

Features

- Female iron pipe thread to female brass pipe threaded connections
- Designed and manufactured to the highest quality standards
- Individually factory certified to withstand a minimum of 600 volts on a dry line with no flashover
- Rated to 82°C at 1720 kPa

Pressure-Temperature

- Maximum Pressure: 1720 kPa
- Maximum Temperature: 82°C

Specification

A dielectric union shall be installed where indicated on the plans. The union shall feature a female iron pipe thread to female brass pipe threaded connections. The union shall be a Watts Series LF3003. The dielectric union shall be constructed using Lead Free* materials. Lead Free* dielectric unions shall comply with state codes and standards, where applicable, requiring reduced lead content.

Installation Dimension

Size	MATERIALS					DIMENSIONS		WEIGHT	Product Code
	TAIL PIECE	ADAPTER †	NUT †	INSULATOR	GASKET**	A	B		
mm						mm	mm	gm	
15	Lead Free Brass	Steel	Steel	Polysulfone	Buna-N	41	57	221	LF3003-015
20	Lead Free Brass	Steel	Steel	Polysulfone	Buna-N	48	57	309	LF3003-020
25	Lead Free Brass	Steel	Steel	Polysulfone	Buna-N	58	64	471	LF3003-025
30	Lead Free Brass	Steel	Malleable Iron	Polysulfone	Buna-N	70	70	666	LF3003-032
40	Lead Free Brass	Malleable Iron	Malleable Iron	Polysulfone	Buna-N	89	70	1262	LF3003-040
50	Lead Free Brass	Malleable Iron	Malleable Iron	Polysulfone	Buna-N	105	79	1905	LF3003-050

† Steel and malleable iron components are zinc plated

NOTICE

The information contained herein is not intended to replace the full product installation and safety information available or the experience of a trained product installer. You are required to thoroughly read all installation instructions and product safety information before beginning the installation of this product.



Standards

- Meets federal specifications for tensile strength and thread end connections

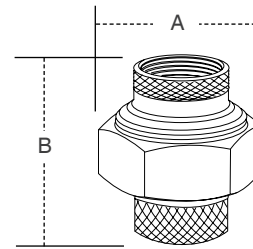

NOTICE

Inquire with governing authorities for local installation requirements

*The wetted surface of this product contacted by consumable water contains less than 0.25% of lead by weight.