

# Series LF3004

## Dielectric Unions

### Size: DN15-DN50

Series LF3004 Dielectric Unions feature female iron pipe thread to female iron pipe thread (zinc plated) connections. These unions are designed to be installed to prevent accelerated corrosion and deterioration in the piping system due to galvanic and stray current. The LF3004 features Lead Free\* construction to comply with Lead Free\* installation requirements.

### Features

- Female iron pipe thread to female iron pipe thread (zinc plated) connections.
- Designed and manufactured to the highest quality standards
- Individually factory certified to withstand a minimum of 600 volts on a dry line with no flashover
- Rated to 82°C at 1720 kPa

### Pressure-Temperature

- Maximum Pressure: 1720 kPa
- Maximum Temperature: 82°C

### Specification

A dielectric union shall be installed where indicated on the plans. The union shall feature a female iron pipe thread to female iron pipe thread (zinc plated) connections. The union shall be a Watts Series LF3004.

### Installation Dimension

Size	MATERIALS					DIMENSIONS		WEIGHT	Product Code
	TAIL PIECE †	ADAPTER †	NUT †	INSULATOR	GASKET	A	B		
mm						mm	mm	gm	
15	Steel	Steel	Steel	Polysulfone	Buna-N	41	57	221	LF3004-015
20	Steel	Steel	Steel	Polysulfone	Buna-N	48	57	309	LF3004-020
25	Steel	Steel	Steel	Polysulfone	Buna-N	58	64	471	LF3004-025
30	Steel	Steel	Malleable Iron	Polysulfone	Buna-N	70	70	666	LF3004-032
40	Malleable Iron	Malleable Iron	Malleable Iron	Polysulfone	Buna-N	89	70	1262	LF3004-040
50	Malleable Iron	Malleable Iron	Malleable Iron	Polysulfone	Buna-N	105	79	1905	LF3004-050

† Steel and malleable iron components are zinc plated

#### NOTICE

The information contained herein is not intended to replace the full product installation and safety information available or the experience of a trained product installer. You are required to thoroughly read all installation instructions and product safety information before beginning the installation of this product.

### Standards

- Meets federal specifications for tensile strength and thread end connections

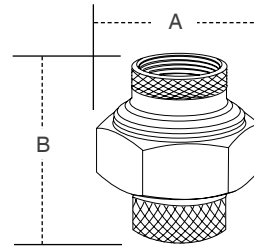

#### NOTICE

Inquire with governing authorities for local installation requirements

\*The wetted surface of this product contacted by consumable water contains less than 0.25% of lead by weight.